

APS 004 Electrothermal units MOBILE 9 KW

Technical description

Thermal electric system adjustable from 1 to 9 Kw, suitable for production water at low and high temperature, complete with circular pump, AT-BT limit probes of temperature, control panel with electronics cards and LCD display, safety valve, pressure gauge and thermometer, stainless resistance steel corrosion resistant, loading and unloading fluid valve, expansion tank.

This unit is supplied fully assembled and wired: it is hydraulically and electrically tested.

Raccomandati applications

- Hot thermal test
- Heating of greenhouses or prefabricated environments
- Temporary emergency heating
- Heating and drying of building parts
- Drying screeds for radiant system

Plus

PIN code protection machine

Production water heating high and low temperature

Adjustable power settable step by step from 1 to 9 kw.

Adjustment operation times



Direzione amministrativa e commerciale

Via Del Parco, 5
20080 Albairate (MI) Italia
Tel (+039) 02.94061133
Fax (+039) 02.94061133

Produzione e laboratorio

Via E. Toti, 32
20080 Albairate (MI) Italia
Tel (+039) 02.94921122
Fax (+039) 02.94921122



Description of the main installed components

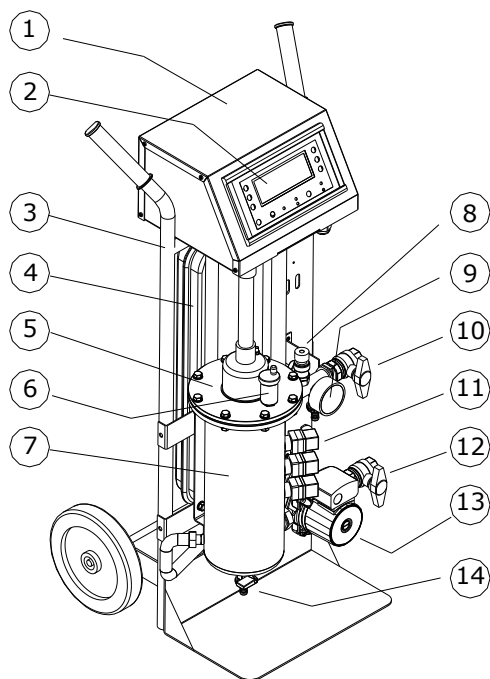

- 1 - Dash electrical board
- 2 - Control panel
- 3 - Metal frame painted
- 4 - Expansion tank 9 liters.
- 5 - Leads resistance boiler body
- 6 - Air valve
- 7 - Electric resistance flange
- 8 - Safety valve 3 bar calib.
- 9 - Thermomanometer control
- 10 - Shut-off valve supply 1"
- 11 - Control group probes and safety
- 12 - Shut-off valve return 1"
- 13 - Circular pump three speeds
- 14 - Unloading fluid valve

Size e dimensions

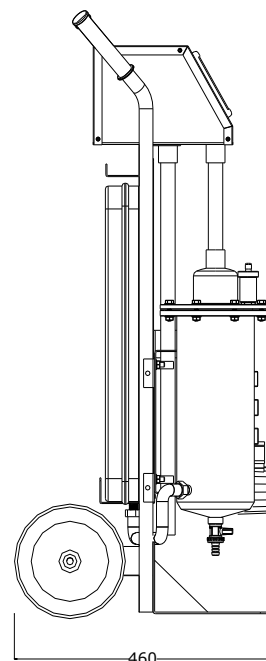
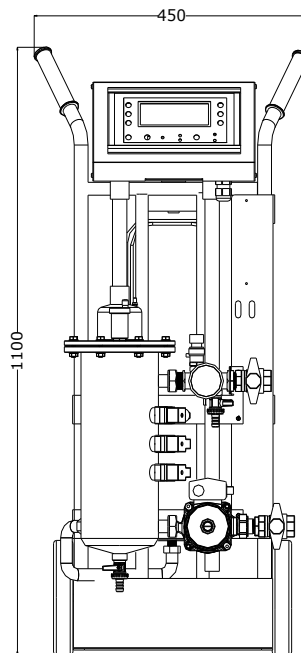
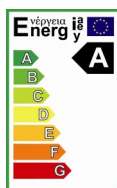

Auxiliary barrel kit

Auxiliary barrel aximum capacity 3 kW, without adjustment, designed and built for the 'use in cases under the main machine APS 004 outside the parameters of installed capacity barrel complete with galvanized steel PN 6, air release valves and exhaust equipment, control panel with start switch indicator light resistance, settable thermostat from 30 to 90 ° C. probe applied to the barrel itself, resistance in nickel-plated brass EC from 3 kw. With threaded diam. 1 1/2 "and plastic protection.

